

MIRAMAR

MADE TO FIT
YOUR ASPIRATIONS



MIRAMAR

 BY THOR MOTOR COACH

WHEN WE SAY *MADE TO FIT*, WE MEAN IT.

With so many unique models available, Thor Motor Coach motorhomes are priced to fit anyone's budget – from families buying their first motorhome, to full-timers looking for a roaming “dream home”. No matter how you choose to spend your time or your money, there's a TMC motorhome that fits your needs. Welcome to the Miramar, the motorhome that is ***Made to Fit*** your aspirations.



34.1 | LUNAR ECLIPSE | GLAZED OLYMPIC CHERRY



33.5 | CHOCOLATE PEARL | SYDNEY MAPLE



34.2 | LUNAR ECLIPSE | GLAZED SYDNEY MAPLE



34.3 | CORNERSTONE | GLAZED OLYMPIC CHERRY





 **THOR**
MOTOR COACH
Made to fit.

BEAUTY INSIDE & OUT



34.3 | CORNERSTONE | GLAZED OLYMPIC CHERRY



CHOCOLATE PEARL



RESIDENTIAL VINYL FLOORING



34.1 | LUNAR ECLIPSE | GLAZED SYDNEY MAPLE



CORNERSTONE



COUNTERTOPS



33.5, 34.2 & 34.4 | EXTERIOR KITCHEN



LUNAR ECLIPSE



OLYMPIC CHERRY

SYDNEY MAPLE



SPICED DELIGHT PARTIAL PAINT 



TAILWIND PARTIAL PAINT 



CRIMSON QUARTZ FULL-BODY PAINT

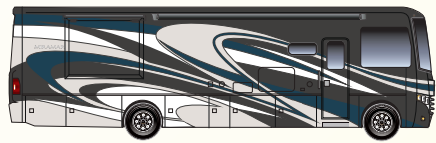

LAKEVIEW FULL-BODY PAINT

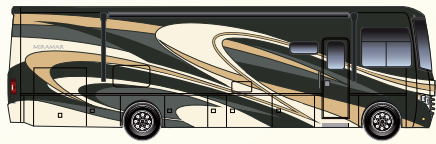

THUNDER BAY FULL-BODY PAINT

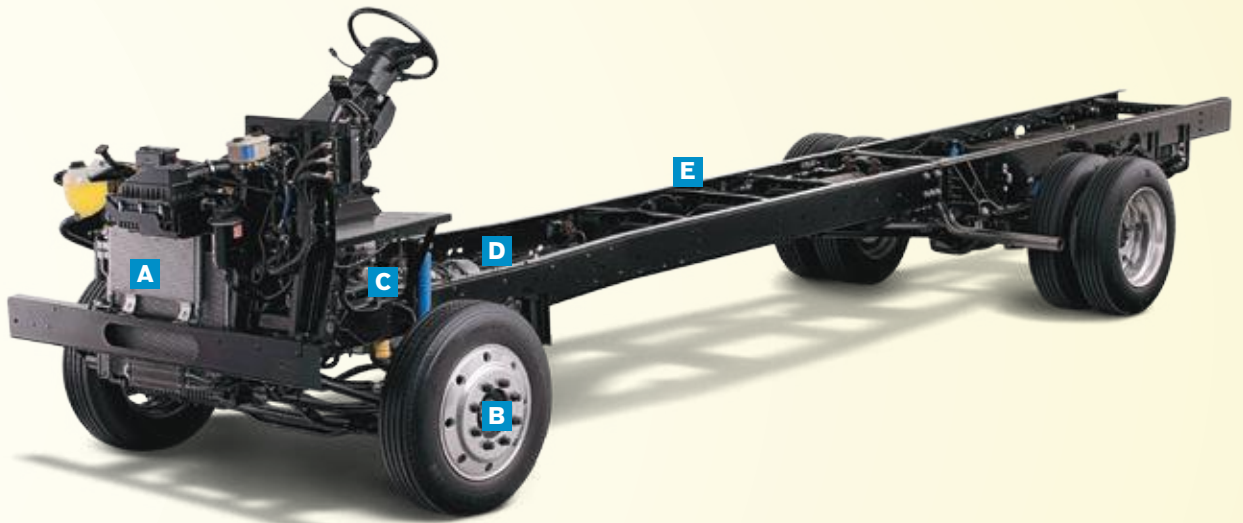

A | TRITON® V10 ENGINE

The 6.8L V10 engine has a proven track record of durability and low-hassle maintenance. Extremely smooth running with a commanding 362-horsepower and 457 lb.-ft. of torque.

B | POWER 4-WHEEL DISC ANTI-LOCK BRAKES

Maintains brake balance in heavy use and varying road conditions. Reduces wheel lock up and helps maintain superior steering control.

C | BILSTEIN SHOCKS

Long lasting, rugged shocks provide greater stability and better road handling.

D | TORQSHIFT™ 6-SPEED AUTOMATIC TRANSMISSION

Provides crisp, firm and quick shifting without sacrificing driver comfort.

E | LIMITED WARRANTY

The Ford® Motorhome Chassis has a Bumper-to-Bumper Limited Warranty for 3 years or 36,000 miles and a Powertrain Limited Warranty for 5 years or 60,000 miles, whichever comes first.

Taking the extra time to ensure the best possible structure is exactly what you deserve, and this is why Thor Motor Coach insists on vacuum-bond laminating not only the sidewalls of the motorhome, but also the floor and roof. Vacuum-bonding is the optimum manufacturing process to ensure maximum strength.

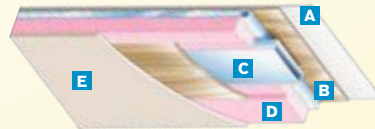

ROOF

- A** One-piece exterior TPO membrane
- B** Luan panels
- C** Aluminum structure with bowed framing
- D** Block foam insulation
- E** Interior panel with soft touch vinyl covering

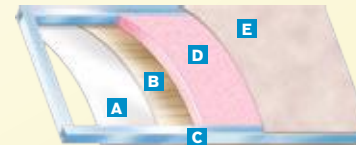

SIDEWALLS

- A** High-gloss or gel-coat fiberglass
- B** Luan panels
- C** Aluminum structure with framing at all openings
- D** Block foam insulation
- E** Interior panel with designer wall covering



FLOOR

- A** Residential vinyl flooring or carpet
- B** OSB structure wood base
- C** Structural steel framing
- D** Block foam insulation
- E** Luan with woven plastic exterior finish

FLOOR PLANS

33.5

Chassis	Ford
Gross Vehicle (GVWR)	22,000
Gross Combined (GCWR)	26,000
Wheel Base	228"
Exterior Length (w/o ladder)	34'-7"
Exterior Height (w/AC)	12'-9"
Exterior Width (w/o mirrors)	101"
Interior Height	82"
Awning Size	20'
Fuel (gal)	80
LPG (lbs)	105
Fresh/Waste/Gray Water (gal)	100 / 40 / 41
Water Heater (gal)	6
Furnace (BTUs)	35,000
Exterior Storage Capacity (cu. ft.)	114.5 / 144.5*

*Without Exterior Kitchen

33.5

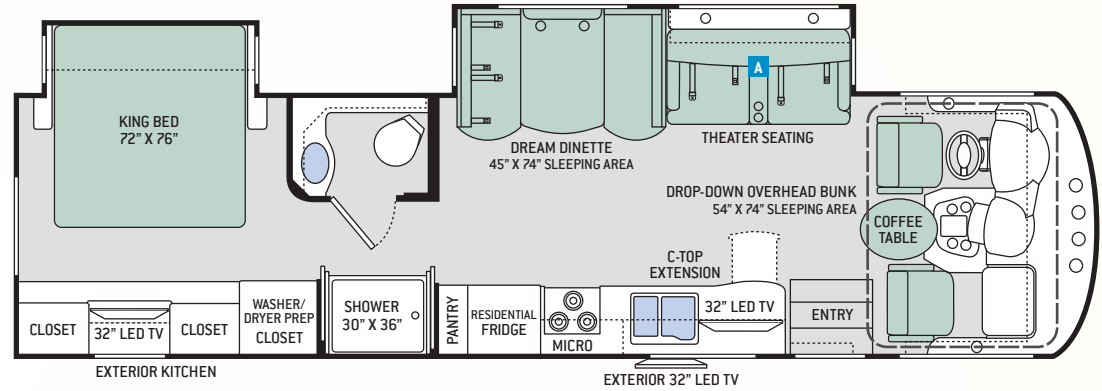

34.1

Chassis	Ford
Gross Vehicle (GVWR)	22,000
Gross Combined (GCWR)	26,000
Wheel Base	242"
Exterior Length (w/o ladder)	35'-10"
Exterior Height (w/AC)	12'-9"
Exterior Width (w/o mirrors)	101"
Interior Height	82"
Awning Size	18'
Fuel (gal)	80
LPG (lbs)	105
Fresh/Waste/Gray Water (gal)	100 / 40F-43R / 40F-43R
Water Heater (gal)	6
Furnace (BTUs)	35,000
Exterior Storage Capacity (cu. ft.)	139.5

34.1

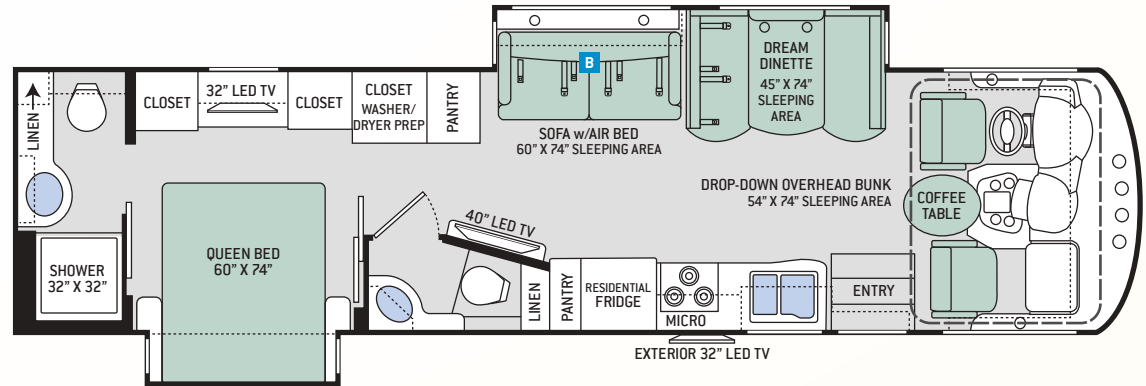

34.2

Chassis	Ford
Gross Vehicle (GVWR)	22,000
Gross Combined (GCWR)	26,000
Wheel Base	242"
Exterior Length (w/o ladder)	35'-10"
Exterior Height (w/AC)	12'-9"
Exterior Width (w/o mirrors)	101"
Interior Height	82"
Awning Size	20'
Fuel (gal)	80
LPG (lbs)	105
Fresh/Waste/Gray Water (gal)	100 / 40 / 43
Water Heater (gal)	6
Furnace (BTUs)	35,000
Exterior Storage Capacity (cu. ft.)	145 / 178*

*Without Exterior Kitchen

34.2

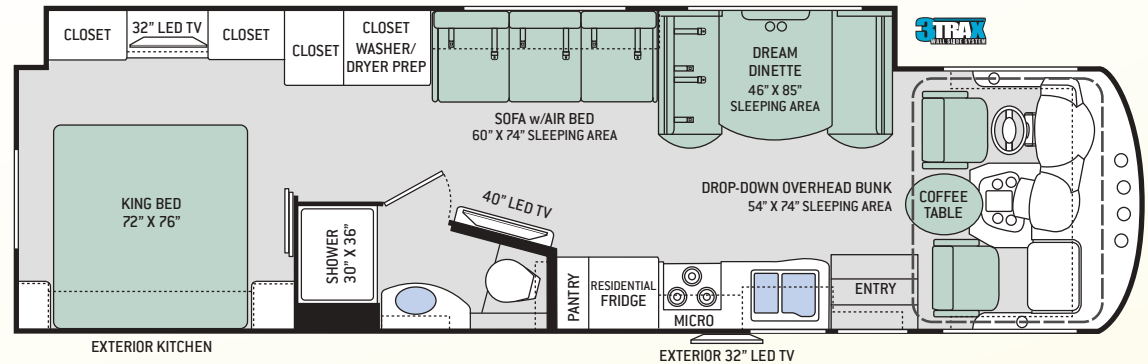

3TRAX™ is our in-wall slideout system, housing all the moving and mechanical parts within the sidewall of the motorhome. This triple track design supports large rooms, like those found in full-wall slideouts, ensuring simple, reliable, maintenance-free operation. What sets 3TRAX™ apart is the patented rail system, in-floor roller guides and electric motor design. For more information, visit thormotorcoach.com/3TRAX.

34.3

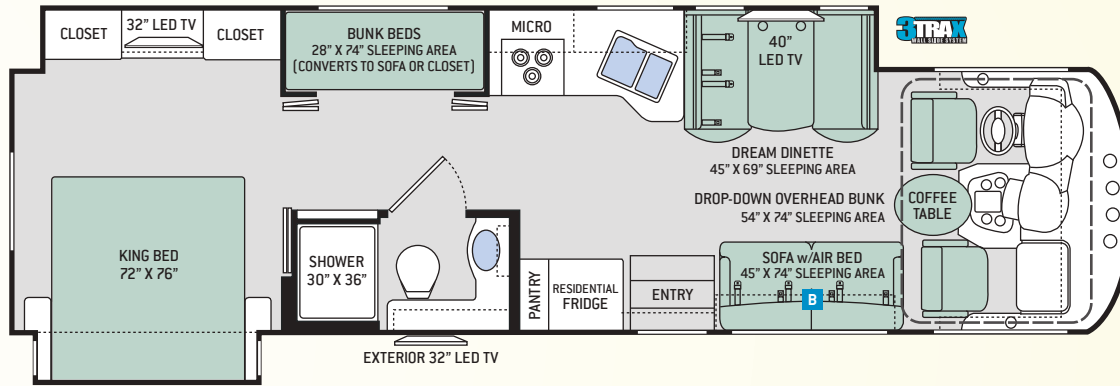

34.4

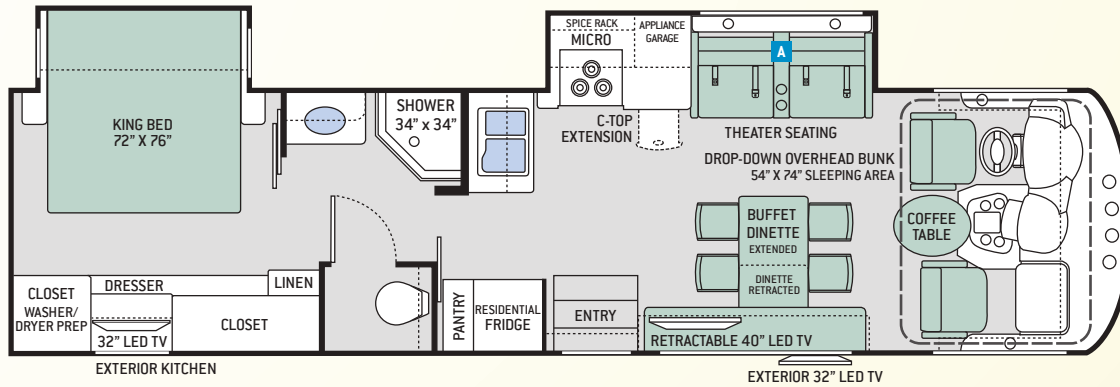

35.2

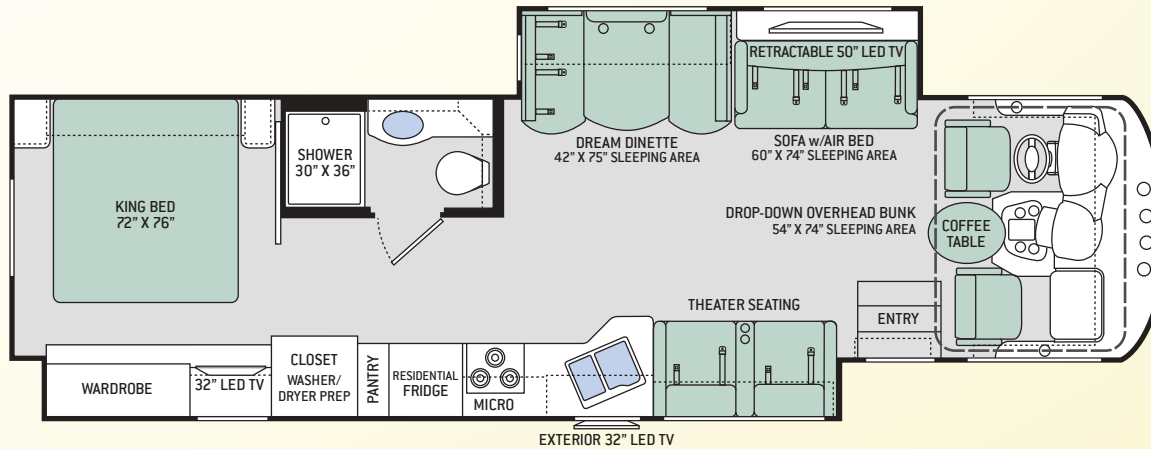

OPTIONS

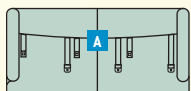

OPTIONAL SOFA w/AIR BED 60" X 74" SLEEPING AREA

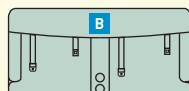

OPTIONAL THEATER SEATING

34.3

Chassis	Ford
Gross Vehicle (GVWR)	22,000
Gross Combined (GCWR)	26,000
Wheel Base	242"
Exterior Length (w/o ladder)	35'-10"
Exterior Height (w/AC)	12'-9"
Exterior Width (w/o mirrors)	101"
Interior Height	82"
Awning Size	20'
Fuel (gal)	80
LPG (lbs)	105
Fresh/Waste/Gray Water (gal)	100 / 40 / 43
Water Heater (gal)	6
Furnace (BTUs)	35,000
Exterior Storage Capacity (cu. ft.)	150.75

34.4



Chassis	Ford
Gross Vehicle (GVWR)	22,000
Gross Combined (GCWR)	26,000
Wheel Base	242"
Exterior Length (w/o ladder)	35'-10"
Exterior Height (w/AC)	12'-9"
Exterior Width (w/o mirrors)	101"
Interior Height	82"
Awning Size	20'
Fuel (gal)	80
LPG (lbs)	105
Fresh/Waste/Gray Water (gal)	100 / 41 / 40
Water Heater (gal)	6
Furnace (BTUs)	35,000
Exterior Storage Capacity (cu. ft.)	164 / 194*

*Without Exterior Kitchen



35.2



Chassis	Ford
Gross Vehicle (GVWR)	22,000
Gross Combined (GCWR)	26,000
Wheel Base	242"
Exterior Length (w/o ladder)	36'-10"
Exterior Height (w/AC)	12'-9"
Exterior Width (w/o mirrors)	101"
Interior Height	82"
Awning Size	20'
Fuel (gal)	80
LPG (lbs)	105
Fresh/Waste/Gray Water (gal)	100 / 40 / 70
Water Heater (gal)	6
Furnace (BTUs)	35,000
Exterior Storage Capacity (cu. ft.)	180

STANDARDS & OPTIONS

CONSTRUCTION & EXTERIOR

- Ford® F-53 Chassis - 6.8L Triton® V10 Engine, 362HP, 457 lb.-ft. Torque - TorqShift® 6-Speed Automatic with Overdrive Transmission
- Fully Welded Tubular Steel Floor System
- Fully Welded Tubular Aluminum Roof & Sidewall Cage Construction
- Vacu-Bond Laminated Roof, Wall & Floor with High-Density Block Foam Insulation
- Premium Crown Roof with TPO 
- HD-MAX® Exterior with Partial Paint & Graphics Package
- Automatic Leveling Jacks with Touchpad Controls
- Power Patio Awning with Integrated LED Lighting
- Power Entry Door Awning (35.2)
- Slideout Room Awnings
- 3TRAX® Wall Slide System (34.2 & 34.3) 
- Full Basement Pass-Through Storage
- Rotocast Storage Compartments
- Locking Exterior Aluminum Compartment Doors
- Pet-Link™ Multi-Purpose Tie-Down
- Roof Ladder
- Double Electric Automatic Entry Step
- Frameless Windows

CONSTRUCTION & EXTERIOR OPTIONS

- Full-Body Paint with Gel-Coat Sidewalls
- Frameless Dual Pane Windows

AUTOMOTIVE & COCKPIT

- Touchscreen AM/FM Dash Radio with CD Player, Bluetooth®, Back-Up Monitor & Mirror Display
- Heated/Remote Exterior Mirrors with Integrated Side View Cameras
- Reclining/Swivel Leatherette Captain's Chairs with Stow-Away Coffee Table in between
- 6-Way Power Adjustment Driver's Seat
- Windshield Electric Privacy Shade
- Manual Side Window Roller Shades
- 22.5" Tires with Aluminum Wheels
- Valve Stem Extenders on Rear Tires
- 8,000-lb. Trailer Hitch with 7-pin Round Connector
- Dash Workstation with 110-volt & 12-volt Outlets

INTERIOR

- Residential Vinyl Flooring Throughout
- 82" Interior Ceiling Height
- Soft Vinyl Ceiling
- LED Ceiling Lights
- Ceiling Ducted Air Conditioning System
- Glazed Cabinetry with Raised Panel Hardwood Cabinet Doors & Nickel Finish Hardware
- Full Extension Metal Ball-Bearing Metal Drawer Guides
- Leatherette Dream Dinette® Booth (33.5, 34.1, 34.2, 34.3 & 35.2)
- Buffet Dinette with Four (4) Chairs - Includes Two (2) Folding Chairs (34.4)
- Leatherette Theater Seating (33.5, 34.4 & 35.2)
- Leatherette Sofa with Air Bed (34.1, 34.2, 34.3 & 35.2)
- Lambrequin Window Treatments
- Window Privacy Roller Shades
- Power Drop-Down Hide-Away Overhead Bunk with Cotton Cloud™ Mattress & Bunk Ladder

INTERIOR OPTIONS

- Leatherette Sofa with Air Bed (33.5 & 34.4)
- Leatherette Theater Seating (34.1 & 34.3)
- Electric Fireplace w/Remote Control (34.1 & 34.2)

KITCHEN

- 11 cu. ft. Residential Refrigerator with Ice Maker
- 3-Burner Gas Cooktop with Oven
- 30" Over-the-Range Microwave Oven
- Solid Surface Kitchen Countertops, Under-Mount Stone Sink & Recessed Stove & Sink Covers
- Kitchen Appliance Garage (34.4)
- Extension Countertop Drawer (33.5 & 34.4)
- Pantry

BEDROOM & BATHROOM

- Denver Mattress® Queen Size Bed (34.1)
- Denver Mattress® King Size Bed (33.5, 34.2, 34.3, 34.4 & 35.2)
- Designer Headboard, Bedspread & Pillow Shams
- Bunk Beds – Converts to Sofa or Closet (34.3)
- Foot Flush Porcelain Toilet

- Power Vent in Bathroom
- Stainless Steel Bathroom Sink*
- Skylight in Shower
- Shower with Glass Door

ENTERTAINMENT

- Entertainment Center w/Retractable 50" LED TV & DVD Player in Living Area (35.2)
- Entertainment Center w/Retractable 40" LED TV & DVD Player in Living Area (34.4)
- Entertainment Center w/40" LED TV & DVD Player in Living Area (34.1, 34.2 & 34.3)
- Entertainment Center w/32" LED TV & DVD Player in Living Area (33.5)
- 32" LED TV in Bedroom
- 13" & 24" LED TVs & DVD Player in Bunk Beds (34.3)
- Bluetooth® Coach Radio System in Bedroom with Exterior Speakers
- Power Charging Center for Electronics
- Cable TV & HDMI Ready
- Digital TV Antenna*
- Exterior 32" LED TV
- Exterior Kitchen w/2.6 cu. ft. Refrigerator, Sink & Portable Gas Grill (33.5, 34.2 & 34.4)

ENTERTAINMENT OPTION

- Storage Area with Shelf IPO of Exterior Kitchen (33.5, 34.2 & 34.4)

ELECTRICAL & PLUMBING

- Cummins Onan® RV QG 5500 Gas Generator
- 50-amp Shoreline Power Cord
- Automatic Generator Start
- 1800-watt Inverter
- Dual Auxiliary House Batteries with Battery Tray that Holds up to Four (4) Batteries
- Battery Disconnect Switch
- Emergency Start Switch
- Dual 13,500 BTU Roof Air Conditioners
- 6-gallon DSI Gas/Electric Water Heater
- Water Heater Bypass System
- Enclosed & Heated Holding Tanks
- Black Tank Flush System
- Washer/Dryer Prep (33.5, 34.1, 34.2, 34.4 & 35.2)
- Systems Control Center
- **Rapid Camp®** Wireless Control System

*INCLUDED ON UNITS BUILT AFTER 10/01/15

Thor Motor Coach is the industry leader in innovative design and builds a variety of unique styles, sizes and floor plans that feel custom-made – at a truly competitive price.

IMPORTANT-PLEASE READ: This brochure reflects product design, fabrication, material, components and specifications at the date of printing, which date is disclosed below. **Please visit us online at ThorMotorCoach.com or consult with your selling dealership for the latest in standards, options, specification and technical information.** Photographs in the brochure may depict optional equipment or may only be available in certain floor plans. Components, appliances and the chassis may have been manufactured in a calendar year before the vehicle's designated model year. All capacities are approximate. The actual length of the vehicle may differ from that indicated in the brochure due to variances in the manufacturing processes and/or installed components. All dry weights are based on standard model features and do not include optional features or equipment. Component part and appliance manufacturers issue limited warranties covering portions of the vehicle not covered under the limited warranty we issue. Copyright Thor Motor Coach, Inc. © 12/15/15



YOUR LOCAL THOR MOTOR COACH DEALER



Made to fit.

P.O. Box 1486, Elkhart, IN 46515
Sales Department: 800.860.5658
Customer Service: 877.855.2867

thormotorcoach.com/miramar